

INTRODUCING

EVENT. Enhance your visitor experience by providing your guests with secure storage solutions for their personal items, making it easier for them to enjoy your facility or activity without having to carry their belongings around.



EVENT

SMART, Secure Storage Solutions

EVENT OVERVIEW

EVENT Smart lockers can be used by a wide range of entertainment venues such as museums, amusement parks, lidos, trampoline parks, sports facilities, allowing your guests access to a user-friendly temporary locker, which they can easily reserve, pay for, and use via your own dedicated locker website.

Products are made to order, so your order gets the attention to detail it deserves. Most frequently specified options are detailed, please call for alternative or bespoke requests on **02920 859600**

EVENT BENEFITS

- The innovative cloud-based technology is highly reliable, secure and easy to manage and use.
- Authentication can be set up with a pass or tag, combination lock, fingerprint, pin code (via the terminal), RFID, QR- or barcode, or the mobile app.
- Users can reserve a locker beforehand or rent on-the-spot through the mobile app, online or the locker SMARTY touchscreen.
- Payment options can be integrated into a payment platform, allowing visitors to pay online beforehand or via the terminal touchscreen (cashless) at the lockers.

COMPANY STANDARDS & MEMBERSHIPS



SOFTWARE SYSTEM

BENEFITS

- **Cost Effective** - no need to invest in software or hardware; subscription based.
- **System** - Plug and play cloud solution. Incl. Smart and connectivity ware. Standard power supply. Standard internet connection.
- **Overview & Analytics** - a Real-time digital dashboard gives an instant overview of every aspect of locker usage, as well as access to past usage statistics.
- **Fallback** - opening locker in case of power failure: manual unlocking by mechanical override. Power failure: UPS. Internet connection fallback 4G unit.
- **ROI** - generate revenue with the most versatile locker system that fits your venue and guest demographics.
- **Administration** - your system can be controlled from your PC, laptop or mobile. Set the right combination of variables depending on the size of locker, time and duration of use and price.
- **Branding** - customise the App with your business logo and colours.

ACCESS METHODS

- QR code

ENVIRONMENTAL GRAPHICS

- With our graphics service, you can personalise your lockers with your brand's logo or enhance your locker with an attractive dynamic design.



EASY LOCKER USE FOR YOUR VISITORS, WITH QR CODE

Quick and Simple!

- Visitors simply scan the QR code: claim, reserve, open / close, leave, pay.
- Share the locker with someone by entering their email and click on the Share button

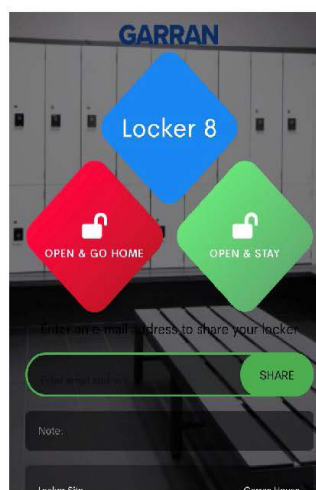
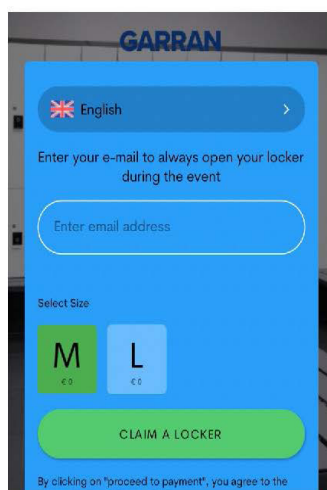

STANDARD SPECIFICATION

- Free-standing unit
- Steel Carcase / Steel Doors
- Steel Carcase / Laminate Doors
- Concealed door hinges
- Standard paint + board finishes
- Secure SMART locking
- Advanced and flexible key-less access control system with integrated control unit
- Perfect for retail, leisure, health, educational, warehousing and office environments

OPTIONAL EXTRAS

- Bespoke / Premium paints, finishes and materials
- Decorative cladding, bespoke sizes
- Steel Carcase / MFC Doors
- MFC Carcase / MFC Doors
MFC is 18mm with 2mm ABS edging
- Aluminium detailing
- Numbering systems
- RFID Card Reader
- Vinyl Graphics
- Management software upgrades including:
 - alarm system
 - email communication support
- Software hosting updates, extended contract

Bespoke options available email
projects@garran-workspaces.co.uk
 for your FREE consultation

1800 HIGH MODULES



ELECB18
CONTROL
MODULE

H 1800mm
W 400mm
D 400mm



ELEA18
BASIC
MODULE

H 1800mm
W 400mm
D 400mm



ELEB18
BASIC
MODULE

H 1800mm
W 400mm
D 400mm



ELEC18
BASIC
MODULE

H 1800mm
W 400mm
D 400mm



ELED18
BASIC
MODULE

H 1800mm
W 400mm
D 400mm



ELEE18
BASIC
MODULE

H 1800mm
W 400mm
D 400mm



ELEF18
BASIC
MODULE

H 1800mm
W 400mm
D 400mm

1200 HIGH MODULES



ELECB12
CONTROL
MODULE

H 1200mm
W 400mm
D 400mm



ELEA12
BASIC
MODULE

H 1200mm
W 400mm
D 400mm



ELEB12
BASIC
MODULE

H 1200mm
W 400mm
D 400mm



ELEC12
BASIC
MODULE

H 1200mm
W 400mm
D 400mm



ELED12
BASIC
MODULE

H 1200mm
W 400mm
D 400mm



ELEE12
BASIC
MODULE

H 1200mm
W 400mm
D 400mm



ELEF12
BASIC
MODULE

H 1800mm
W 400mm
D 400mm

MOST FREQUENTLY SPECIFIED OPTIONS



VINYL GRAPHIC - OPTIONAL EXTRA

- With our graphics service, you can personalise your lockers with your brand's logo or enhance your locker with an attractive dynamic design.



MFC

DOOR / CARCASE FINISHES

Most popular below. Lots more available, MOQs and prices vary.



GREY



GRAPHITE

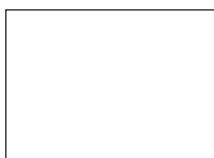

WHITE



OAK

Bespoke options available email
projects@garran-workspaces.co.uk
for your FREE consultation

STEEL PAINT

DOOR / CARCASE FINISHES

Paints unless detailed below are MATT finish - 30% Gloss.
Feature BioCote antimicrobial technology which reduces the presence of microbes by up to 99.99%. BioCote is permanent and complements existing cleaning practices.



STANDARD COLOURS



BLACK
GAK-MN204E



IRIS
GAK-EJ201E



WHITE RAL 9003
GAK-MA585E



IRISH
GAK-EK280E



LIGHT GREY
GAK-EL206E



CORNFLOWER
GAK-EJ203E



POPPY
GAK-EG290E



FLINT
GAK-EL209E

PREMIUM COLOURS - OPTIONAL EXTRA - MOQ 10* Units



SILVER - TEXTURE
GAK-MW333E



GLACIER
GAK-EK216E



HEATHER
GAK-EH227E



PEARL
GAK-ED204E



CHOCOLATE
GAK-EM210E



PINE GREEN
GAK-EF200E



NEW
CLEAR LACQUER
FINISH



REEF
GAK-EK221E



DAFFODIL
GAK-EE250E



SAND
GAK-EE220E



PASTEL ORANGE
RAL 2003
*MOQ 20



SILVER
RAL 9006

Clear lacquer, BioCote antimicrobial coating not included.

SGL - DOOR FINISHES

Solid Grade Laminate - 10mm, double sided decorative board designed to meet the most demanding specifications for interior applications.

Ideal for areas with high levels of humidity, and applications requiring superior hygiene and maintenance levels.

FAST TRACK - STOCKED SGL



DUST



DARK GREY



ELECTRIC BLUE



RED DYNASTY



PEARLY WHITE

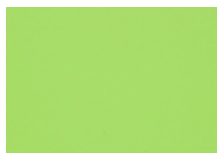

LIME



LIME YELLOW



REFRESH OAK

Bespoke options available email
projects@garran-workspaces.co.uk
for your FREE consultation

SUSTAINABLE DESIGN

Ongoing investment in facilities, equipment and systems means we continuously improve business efficiency, whilst significantly enhancing the working environment for our people.

